

11 Moat Farm Road Northolt UB5 5DR

Price Guide: £400,000

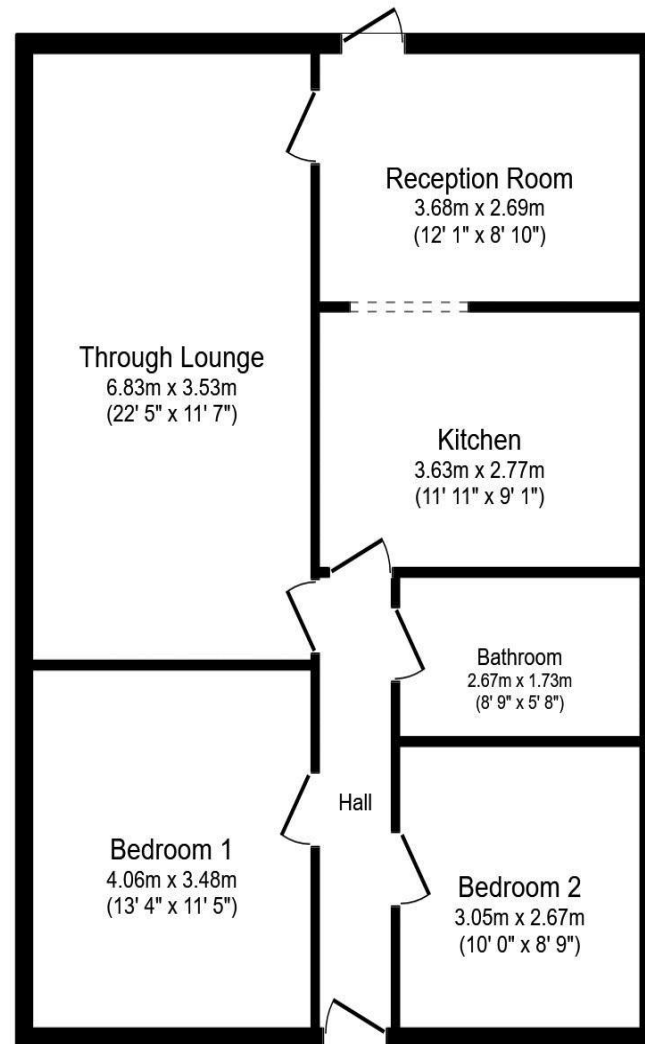

Bennett Holmes are pleased to offer this two double bedroom, extended, semi detached bungalow situated on a popular residential road in Northolt. The property is situated within minutes walk to the main High street with its selection of shops and restaurants and the Central Line Station. Other benefits include a full width rear extension, two reception rooms, gas central heating, a large rear garden and NO UPPER CHAIN.

Total floor area 81.1 sq. m. (873 sq. ft.) approx
This plan is for illustration purposes only and may not be representative of the property. Plan not to scale.

FREEHOLD
LONDON BOROUGH OF EALING
COUNCIL TAX BAND D - £1,571.22

NORTHOLT OFFICE

83 Oldfields Circus, Northolt, Middlesex UB5 4RU

sales: 020 8423 2222 lettings: 020 8423 0222

northolt@bennetholmes.com

IMPORTANT Bennett Holmes would inform prospective purchasers that these sales particulars have been prepared as a general guide only. A detailed survey has not been carried out, nor the services, appliances and fittings tested. Room sizes should not be relied upon for furnishing purposes and are approximate. If floor plans are included, they are for guidance only and illustration purposes only and may not be to scale. If there are any important matters likely to affect your decision to buy, please contact us before viewing the property.



- TWO DOUBLE BEDROOMS
- SEMI DETACHED BUNGALOW
- VACANT - NO UPPER CHAIN
- EXTENDED
- GAS CENTRAL HEATING
- LARGE REAR GARDEN
- COUPLE OF MINUTES WALK TO NORTHOLT TUBE
- TWO RECEPTION ROOMS

**11 Moat Farm Road
Northolt
UB5 5DR**

Price Guide: £400,000



Accommodation

The accommodation briefly comprises an entrance hallway with doors to two double bedrooms, the family bathroom, the through lounge and the kitchen. From the through lounge and the kitchen there are doors to the second reception room. From the second reception room there are patio doors to the rear garden.

Outside the property is a large rear garden. To the front of the property is a front garden.

